

Waste Water Treatment

Sand Washers CLSW



Description ▼

Sand Washers CLSW are used to separate the sand contained in waste water and to wash it at the same time in order to reduce the quantity of organic particles.

The water and sand mixture falls into the truncated cone-shaped tank and spreads due to the agitator rotation. Wash water is used during mixing helping separate the organic particles from the effluent. Wash water is introduced through a sleeve connected to a solenoid valve and to a flow meter (controlling the inlet flow). The tank base has a double bottom whose upper part is equipped with holes for the wash water flow.

An agitator keeps the sand moving conveying it towards the centre of the tank where there is a hole for the connection to the screw conveyor. The different density of the organic particles makes them float while sand with a particle size of more than 300 µm sinks to the tank bottom. The clean water flows through a weir placed inside the tank. The tank is connected to a screw conveyor with a 45° incline angle. The screw conveyor reduces the sand bed inside the inlet hopper and conveys the washed grit to the outlet.

Application ▼



Benefits ▼

- ✓ High efficiency in separating water from sand;
- ✓ High efficiency in reducing organic particle content;
- ✓ Savings in operating costs and maintenance.



www.savi-water.com
www.wamgroup.com

Waste Water Treatment

Sand Washers CLSW



Technical Features / Performance

- ▶ 3 sizes available
- ▶ Flow rates up to 30 l/s
- ▶ 97% organic separation efficiency
- ▶ Frame manufactured from 304 L / 316 L SS
- ▶ Spiral manufactured from special ST 52 steel, or 304 L / 316 L SS
- ▶ Control panel (option)

SAND WASHER CLSW - FLOW RATES

MODEL	NOMINAL FLOW RATE - m ³ /h	SEPARATED SAND - kg/h	WATER CONSUMPTION - l/min at 2 bar
CLSW 10	10	180 - 300	25
CLSW 20	20	400 - 600	40
CLSW 30	30	800 - 1,000	40

Overall Dimensions

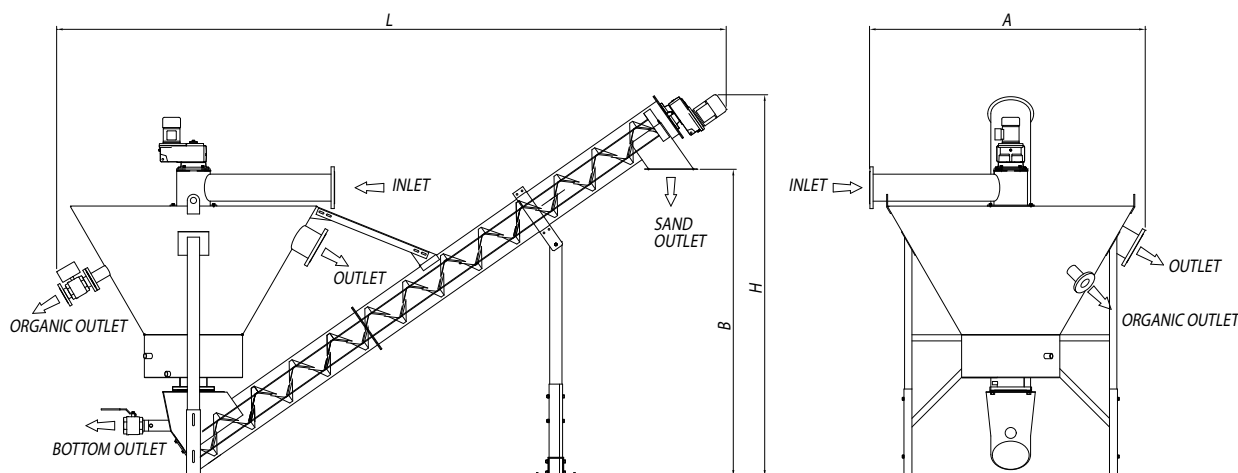

CLSW - SAND WASHER

MODEL	WIDTH A mm	LENGTH L mm	HEIGHT H mm	DISCHARGE HEIGHT B mm	SPIRAL DIAMETER mm	INLET DN (PN 10)	OUTLET DN (PN 10)	MIXER INSTALLED POWER kW	DRIVE POWER kW
CLSW 10	2,300	5,500	3,100	2,500	240	80	150	0.37	1.1
CLSW 20	2,300	5,500	3,100	2,500	280	150	200	0.37	1.1
CLSW 30	2,300	5,500	3,100	25,00	280	150	250	0.37	1.1

DS.CLSWEN October 2015.800 Rights reserved to modify technical specifications.



Available from:
FILQUIP Pty Limited

5/126 Compton Rd, Underwood,
Qld 4119 Australia
Ph: +61 7 3208 3499 Fx: +61 7 3208 3449
Email: sales@filquip.com.au
www.filquip.com.au