

# Waste Water Treatment

## Sub-vertical Mechanical Bar Screens GVB



### Description ▼

GVB Sub-vertical Mechanical Bar Screens consist of a robust steel frame and a bar filter, varying according to the screening efficiency required.

GVB screens are used for coarse screening in both municipal and industrial waste water plants.

Waste water flows into the upstream end of the unit where screenings are captured on the bars.

Chain-driven rakes clean the bars, conveying at the same time the solids to the discharge point.

There material is removed from the rakes by a wiper and discharged into a dumpster, conveyor or compactor.

### Application ▼



### Benefits ▼

- ✓ Precision laser-cut raking tines cut from single stainless steel bar;
- ✓ Recessed guide channels for drive chains reducing chain exposure to screenings;
- ✓ Lower chain guide with no moving parts;
- ✓ No lower sprocket nor bearings;
- ✓ Reduced service requirements (no need to take screen out of channel).



[www.savi-water.com](http://www.savi-water.com)  
[www.wamgroup.com](http://www.wamgroup.com)

# Waste Water Treatment

## Sub-vertical Mechanical Bar Screens GVB



### Technical Features / Performance

- ▶ > 12mm ~ 50mm spacing
- ▶ 2 or more cleaning rakes ensuring quick, efficient solids removal
- ▶ Channel width: 400 ~ 2,000mm
- ▶ 75-degree incline angle
- ▶ Material: hot dip galvanised steel, 304 L / 316 L SS
- ▶ Incline angle other than 75 degrees up to 90 degrees with goose neck (option)
- ▶ Control panel (option)

**GVB - SUB-VERTICAL MECHANICAL BAR SCREEN - FLOW RATES**

MODEL   FLOW RATE m³/h	12 mm	15 mm	20 mm	25 mm	40 mm
GVB 400	120	160	190	200	210
GVB 600	230	310	360	390	420
GVB 800	350	450	540	580	610
GVB 1000	450	600	720	760	810
GVB 1200	560	750	880	950	1,010
GVB 1400	670	890	1,060	1,130	1,210
GVB 1600	780	1,040	1,230	1,320	1,400
GVB 1800	880	1,190	1,410	1,500	1,600
GVB 2000	990	1,330	1,580	1,690	1,800

- Fixed parameters: screening zone height: 1 m
- Screen slope: 75°
- Head loss: 250 mm
- Values related to municipal waste water, screen partially occluded (30%)

### Overall Dimensions

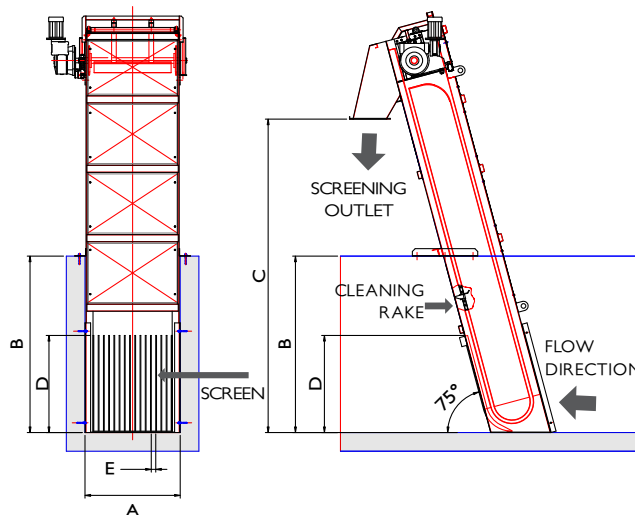

**GVB - SUB-VERTICAL MECHANICAL BAR SCREEN**

MODEL (*)	CHANNEL WIDTH A mm	CHANNEL HEIGHT B m	DISCHARGE HEIGHT FROM CHANNEL BOTTOM C mm	STANDARD SCREENING ZONE HEIGHT D mm (**)	OPENING SIZES mm (*)	INSTALLED POWER kW
GVB 400	400	1 ÷ 10	customer's requirement	1,000	from 12 to 40 mm	0.75
GVB 600	600	1 ÷ 10	customer's requirement	1,000	from 12 to 40 mm	0.75
GVB 800	800	1 ÷ 10	customer's requirement	1,000	from 12 to 40 mm	0.75
GVB 1000	1,000	1 ÷ 10	customer's requirement	1,000	from 12 to 40 mm	1.1
GVB 1200	1,200	1 ÷ 10	customer's requirement	1,000	from 12 to 40 mm	1.1
GVB 1400	1,400	1 ÷ 10	customer's requirement	1,000	from 12 to 40 mm	1.1
GVB 1600	1,400	1 ÷ 10	customer's requirement	1,000	from 12 to 40 mm	1.5
GVB 1800	1,400	1 ÷ 10	customer's requirement	1,000	from 12 to 40 mm	1.5
GVB 2000	1,400	1 ÷ 10	customer's requirement	1,000	from 12 to 40 mm	1.5

(\*) these are standard models; intermediate values are available

(\*\*) standard height of the screening zone: 1,00 m, different heights available

**SAVI**



**Available from:**  
**FILQUIP Pty Limited**

5/126 Compton Rd, Underwood,  
Qld 4119 Australia  
Ph: +61 7 3208 3499 Fx: +61 7 3208 3449  
Email: sales@filquip.com.au  
www.filquip.com.au