

# Waste Water Treatment

## GRITSEP - FGC Fluid Dynamic Grit Classifiers

26



### Description ▼

The GRITSEP FGC Fluid Dynamic Grit Classifier is an innovative sand and grit classifier designed using advanced simulation software to be the most compact, economical solution, engineered for easy on-site assembly, reduced storage and transportation cost, as well as minimum maintenance costs.

### Function ▼

| GRITSEP FGC consists of a separation tank, an extracting screw and a support structure.



### Application ▼

In all waste water treatment plants the process of sedimentation and removal of the sand is essential to preserve functional efficiency of the plant.

GRITSEP FGC special fluid dynamic features have been designed to achieve a high level of sand/grit separation from sewage as well as extraction and dewatering of solids residue.

### Benefits ▼

- ✓ 95% sand removal for grain size  $> 0.2$  mm and 2.60 - 2.65 specific gravity;
- ✓ Durable heavy-duty shaftless screws;
- ✓ Durable, high-density SINT® engineering polymer anti-wear profile (option);
- ✓ Low cost for transportation, installation and maintenance.



Available from:  
**FILQUIP Pty Limited**

5/126 Compton Rd, Underwood,  
Qld 4119 Australia

Ph: +61 7 3208 3499 Fx: +61 7 3208 3449

Email: [sales@filquip.com.au](mailto:sales@filquip.com.au)

[www.filquip.com.au](http://www.filquip.com.au)

# Waste Water Treatment

## GRITSEP - FGC Fluid Dynamic Grit Classifiers



### Technical Features / Performance ▼

- ▶ Sand separation with particle size  $\geq 0.2\text{mm}$  and bulk density from  $2.60$  to  $2.65 \text{ kg/dm}^3$
- ▶ Fully welded tank
- ▶ Low drive power installed
- ▶ Small footprint

Model	Maximum Flow Rate	Average Sand Extraction
	m <sup>3</sup> /h	l/s
005	18	0.18
008	30	
015	54	
025	90	
036	130	

### Overall Dimensions ▼

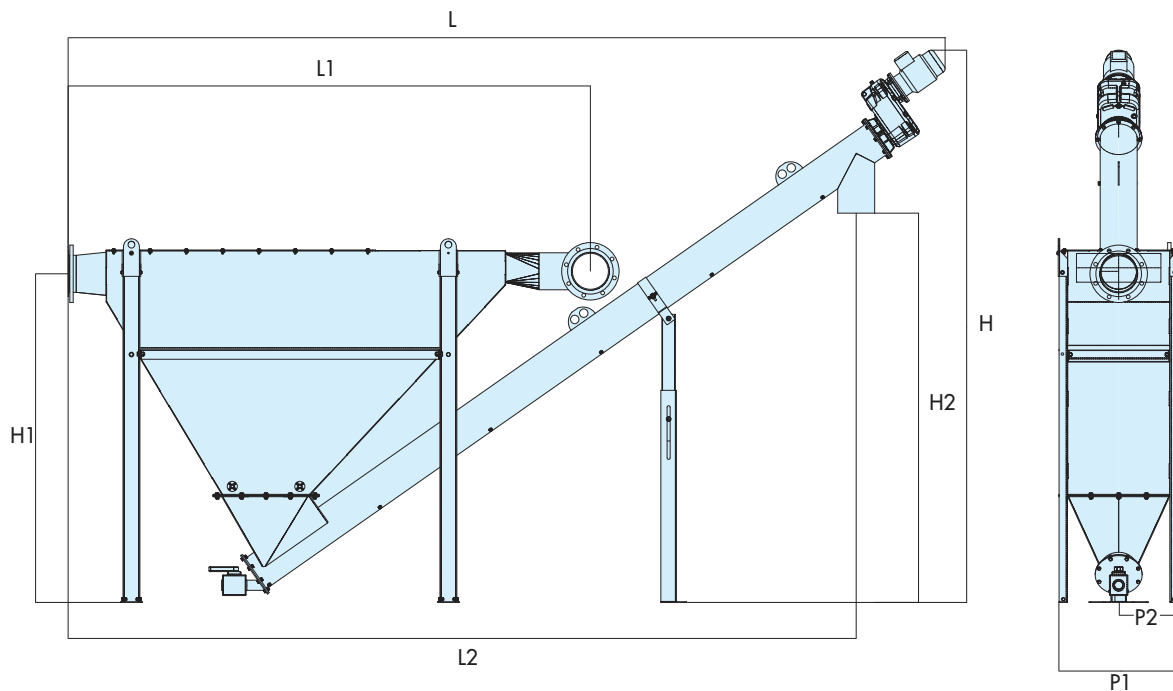

Type	L	L1	L2	H	H1	H2	P1	P2
FGC 005	4,300	2,245	3,600	2,500	1,450	1,650	431	220
FGC 008	4,300	2,286	3,600	2,500	1,450	1,650	631	320
FGC 015	5,400	3,125	4,700	3,000	1,950	2,150	716	365
FGC 025	5,400	3,200	4,700	3,000	2,000	2,150	816	415
FGC 036	5,400	3,275	4,700	3,000	2,000	2,150	1,016	478

Dimensions in mm



Available from:  
**FILQUIP Pty Limited**

5/126 Compton Rd, Underwood,  
Qld 4119 Australia

Ph: +61 7 3208 3499 Fx: +61 7 3208 3449

Email: [sales@filquip.com.au](mailto:sales@filquip.com.au)

[www.filquip.com.au](http://www.filquip.com.au)