

Submersible Choppers **WSA**



Description ▼

The WSA Submersible Choppers consist of a waterproof cast iron body with internal electric motor and a special impeller. The drive unit enables the impeller that has a geometry meant for high effectiveness thus making possible to homogenize the floating solids to the material settled on the tank bottom.

Function ▼

The Submersible Chopper WSA has been designed to mix the material, prevent it from getting settled on the bottom of the tank and make it suitable, after being treated by a chopper pump, for being fed in a separator. The WSA Submersible Chopper allow to preserve in good conditions the fibrous materials collecting tank by avoiding deposits on its bottom and it prevents potential clogging of the pumps and separators.



Application ▼

The WSA Submersible Chopper, available in various sizes, find its most typical application in manure processing due to its mixing function that ensures high performances of the chopper pumps for the feeding of separators or in conveying of sewage or waste water. The Submersible Chopper WSA-type can also be used in biogas plants (in concrete open tanks) for the treatment of sewage (pigs and poultry) and in the treatment of the waste water.

Benefits ▼

- ✓ **Wide range available;**
- ✓ **Sturdy design;**
- ✓ **Excellent mixing performance;**
- ✓ **Quick installation;**
- ✓ **Easy maintenance;**
- ✓ **Low running costs.**



Available from:
FILQUIP Pty Limited

5/126 Compton Rd, Underwood,
Qld 4119 Australia
Ph: +61 7 3208 3499 Fx: +61 7 3208 3449
Email: sales@filquip.com.au
www.filquip.com.au

Submersible Choppers

WSA



Technical Features / Performance ▼

- ▶ Drive unit power rating: 1.5 Kw – 7.5 Kw
- ▶ Effective mixing up to 40 meters

Overall Dimensions ▼

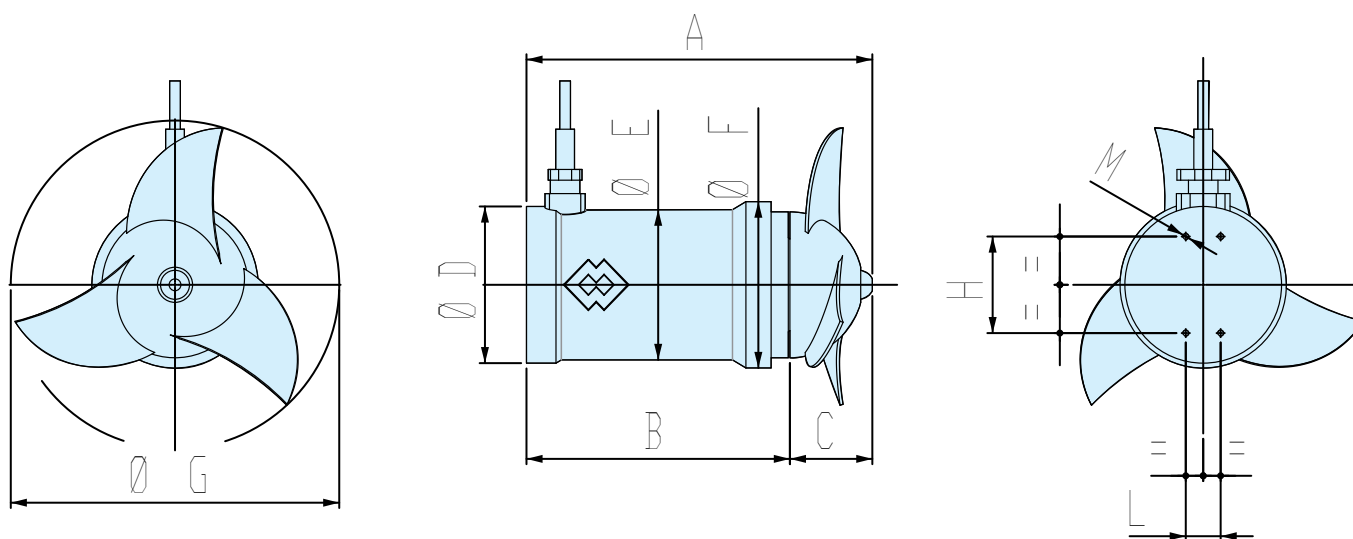

| Type | DIMENSIONS (mm) | | | | | | | | | | Weight (kg) |
|--------|-----------------|-----|-----|-----|-----|-----|-----|-----|----|--------------|-------------|
| | A | B | C | Ø D | Ø E | Ø F | Ø G | H | L | M | |
| WSAL15 | 464 | 386 | 78 | 200 | 177 | 200 | 260 | 80 | 40 | 4x M10 bores | 65 |
| WSAL22 | 570 | 488 | 82 | 227 | 195 | 225 | 320 | 80 | 40 | 4x M10 bores | 93 |
| WSAL30 | 605 | 519 | 86 | 245 | 230 | 259 | 395 | 130 | 65 | 4x M10 bores | 119 |
| WSAL40 | 578 | 446 | 132 | 292 | 277 | 310 | 600 | 180 | 65 | 4x M10 bores | 173 |
| WSAL55 | 633 | 501 | 132 | 292 | 278 | 310 | 600 | 180 | 65 | 4x M10 bores | 192 |
| WSAL75 | 688 | 556 | 132 | 292 | 277 | 310 | 600 | 180 | 65 | 4x M10 bores | 218 |

Available from:

FILQUIP Pty Limited

5/126 Compton Rd, Underwood,
QLD 4119 Australia

Ph: +61 7 3208 3499 Fx: +61 7 3208 3449

Email: sales@filquip.com.au

www.filquip.com.au

This datasheet does not show the complete range but only the models specialised for the application.

