

Available from:
FILQUIP PTY LIMITED
24 Smallwood Street
Underwood, Qld 4119, Australia
Ph: +61 7 3208 3499 sales@filquip.com.au
www.filquip.com.au

ROTARY VALVES

RV DROP-THROUGH ROTARY VALVES

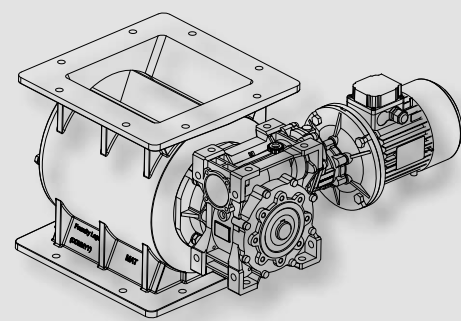

RVR DROP-THROUGH ROTARY VALVES

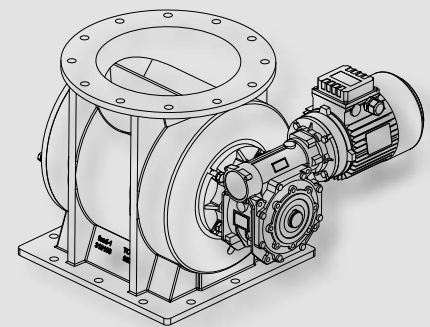

RVC DROP-THROUGH ROTARY VALVES

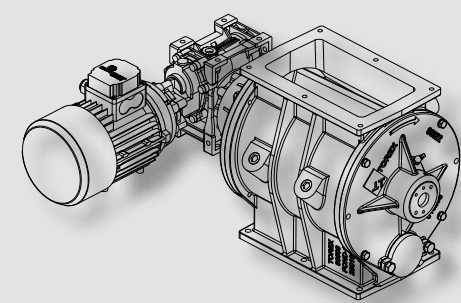

RVS BLOW-THROUGH ROTARY VALVE

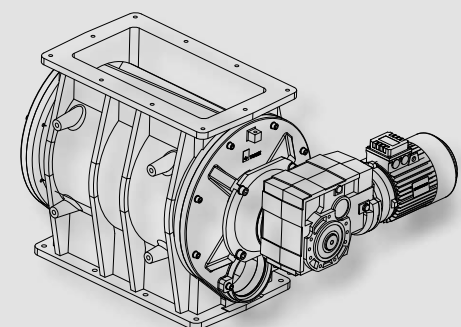

RWN ROTARY VALVE FOR PELLETS AND WOOD CHIPS

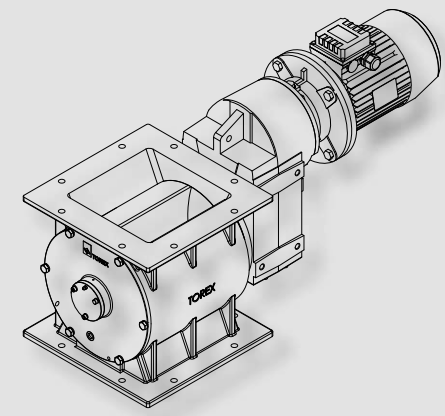

SECTORS OF APPLICATION



CONSTRUCTION



FOOD &
ANIMAL FEED



PLASTICS &
CHEMICALS



HEAVY
INDUSTRY



RENEWABLE
ENERGY



PLANTS
& MACHINERY



ENVIRONMENTAL
TECHNOLOGIES

RV-RVR DROP-THROUGH ROTARY VALVES

The drop-through rotary valves mod. **RV-RVR** have been designed according to a criterion of maximum universal application. They are suitable for controlled feeding or unloading of powder or granular products from silos, hoppers, pneumatic transport systems, filters and cyclones. Thanks to the different construction materials and the appropriate accessories, they can be adapted to the characteristics of each product and to any customer need.

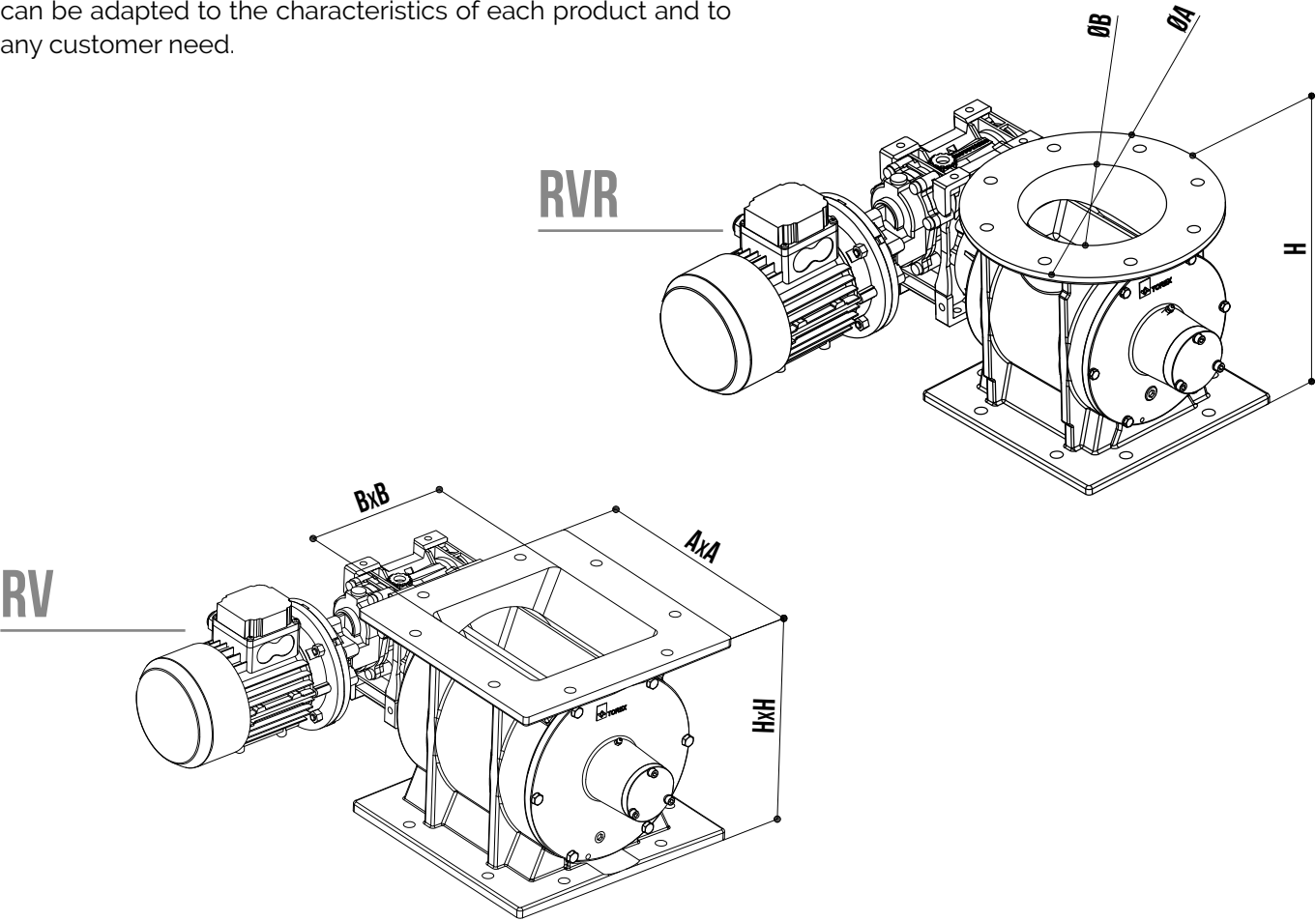

RV MODEL (dimensions in mm)

Type	A	B	H
RV 02	265	150	220
RV 05	320	200	280
RV 10	375	250	360
RV 20	440	300	445

RVR MODEL (dimensions in mm)

Type	A	B	H
RVR 02	285	160	250
RVR 05	340	200	330
RVR 10	406	265	360
RVR 20	445	300	455

TECHNICAL DATA

- Round inlet diameter: 150 mm (6") - 200 mm (8") - 250 mm (10") - 300 mm (12");
- Square inlet diameter: 150x150 mm - 200x200 mm - 250x250 mm - 300x300 mm (6"x6" - 8"x8" - 10"x10" - 12"x12");
- Capacity: 2-5-10-20 litres/rev (0.07 - 0.17 - 0.35 - 0.7 cu ft/rev);
- Working temperature: from -40°C up to 180°C;
- Working pressure: from -0.2 bar up to +0.3 bar;
- Construction material: cast iron, 304 stainless steel, AISI 316 stainless steel only for RV.

RV-RVR...X

Atex rotary valves

ATEX20/22 certified

UE certificate, type TÜV IT 16 ATEX 063 X



Ex h IIIC T135°C Da/Dc

ATEX rotary valves are designed and tested for use in potentially explosive areas classified as ZONA 22 and with a process atmosphere (inside the valve) classified as ZONA 20 in accordance with Directives 2014/34/EU and 1999/92/EC.

RV-RVR...E

Fire stop rotary valves

ATEX20/22 and EN 15089 certified

(Explosion protection systems)

UE certificate, type FTZÚ 13 ATEX 0148 X



Ex h IIIC T135°C Da/Dc



Rotary valves certified as explosion protection system for pressure up to 1.2 bar.





RV-RVR DROP-THROUGH ROTARY VALVES

CONFIGURATION

RV	10	20	1	A	A	A	A	S	0
	CAPACITY	MOTORISATION	BODY MATERIAL (a)	SILLS	SEALS AND BEARINGS	BODY TREATMENT	ROTOR TREAT. AND MAT.	VALVE VERSION	ROTATION IND. KIT
									0 Without rotation indicator 1 With rotation indicator 2 Rotation ind. without sensor
								S Standard X ATEX 20/22	
								C Teflon-coated rotor D Nickel-plated rotor G Partialised rotor H AISI 304 rotor M AISI 316 rotor T Tungsten carbide coating o Standard	
								A Chrome-plated body B Teflon-coated body and cover C Nickel-plated body and cover T Tungsten carbide body o Standard	
								A High temperature seals B Flushed seals o Standard seals	
								A Vulkollan sills B Viton sills C Harmonic steel sills D Teflon sills 7 AISI 316 bevelled blades 2 AISI 304 bevelled blades o Without sills	
								1 Cast iron 2 AISI 304 5 AISI 316	
								AN Bare shaft 10 Revolutions per minute 20 Revolutions per minute 30 Revolutions per minute TC chain drive	
								02 Capacity 2 litres per revolution 05 Capacity 5 litres per revolution 10 Capacity 10 litres per revolution 20 Capacity 20 litres per revolution	
								RV RV type rotary valve (square flanges) RVR RVR type drop-through rotary valve (round load flange/square unload flange)	

RVC DROP-THROUGH ROTARY VALVE

RVS BLOW-THROUGH ROTARY VALVE

High filling coefficient, minimum leakage. Ideal for unloading and feeding powder and granules in every industrial sector.

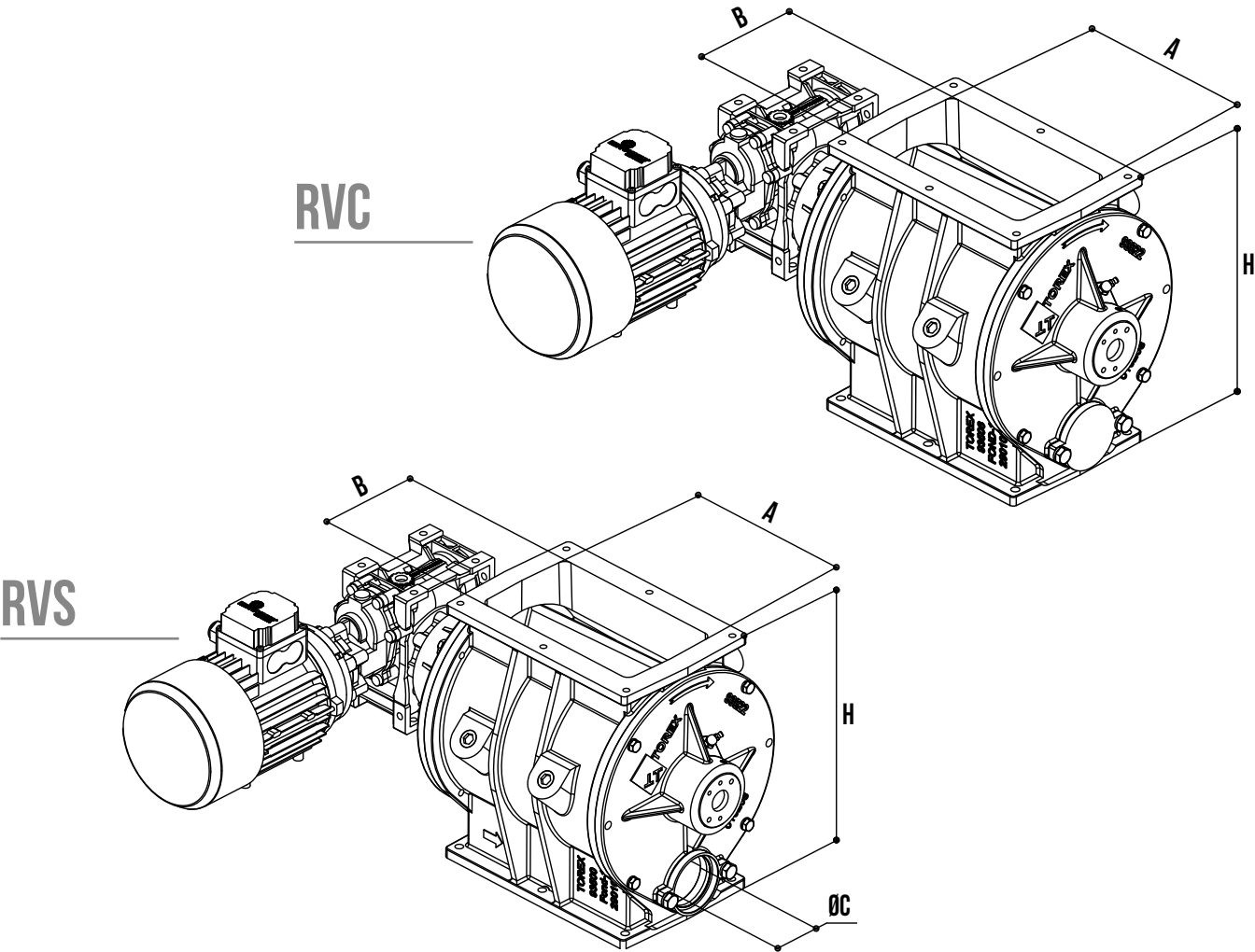

RVC MODEL (dimensions in mm)

Type	A	B	H
RVC 05	170	122	335
RVC 10	238	135	339
RVC 15	276	148	399
RVC 20	337	196	447
RVC 35	470	240	530
RVC 80	569	284	677

RVS MODEL (dimensions in mm)

Type	A	B	C	H
RVS 05	170	122	54	335
RVS 10	238	135	64	339
RVS 15	276	148	74	399
RVS 20	337	196	96	447
RVS 35	470	240	118	530
RVS 80	569	284	150	677

TECHNICAL DATA

- Capacity 5 – 10 – 15 – 20 – 38 – 78 litres/rev;
- Working temperature: from -40°C to +220°C;
- Working pressure: from -0.2 bar to +0.8 bar;
- Open rotor with inclined and chamfered blades or with standard blades;
- Construction material: cast iron, chrome-plated cast iron, nickel-plated cast iron, teflon-plated cast iron and 304 stainless steel.

RVS-RVC...X

Atex rotary valves

ATEX20/22 certified

EU certificate, type TÜV IT 16 ATEX 063 X



Ex h IIIC T135°C Da/Dc

ATEX rotary valves are designed and tested for use in potentially explosive areas classified as ZONA 22 and with a process atmosphere (inside the valve) classified as ZONA 20 in accordance with Directives 2014/34/EU and 1999/92/EC.

RVC...E

Fire stop rotary valves

ATEX20/22 and En 15089 certified

(Explosion protection systems)

EU certificate, type FTZÚ 1A ATEX 0053X



Ex IIIC T135°C Da/Dc



Rotary valves certified as explosion protection system for pressure up to 6 bar.

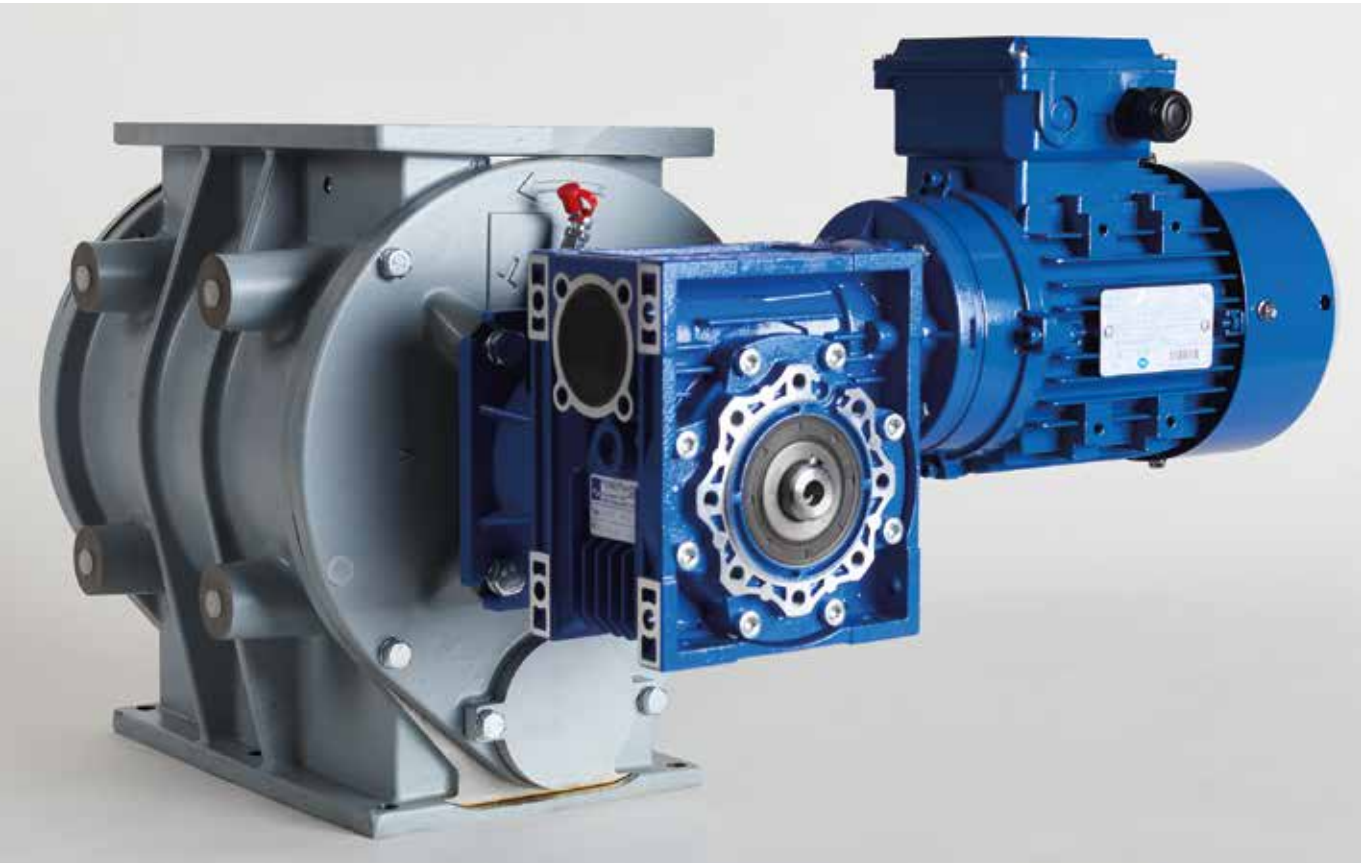



RWN ROTARY VALVE FOR PELLETS AND WOOD CHIPS

The **RWN** rotary valves are designed to unload pellets and wood chips. Thanks to their high cutting action and reduced compressive force, the robust construction guarantees complete protection against backfire, while the motorisation installed directly on the shaft without joints or assemblies ensures easy access to internal mechanical parts.

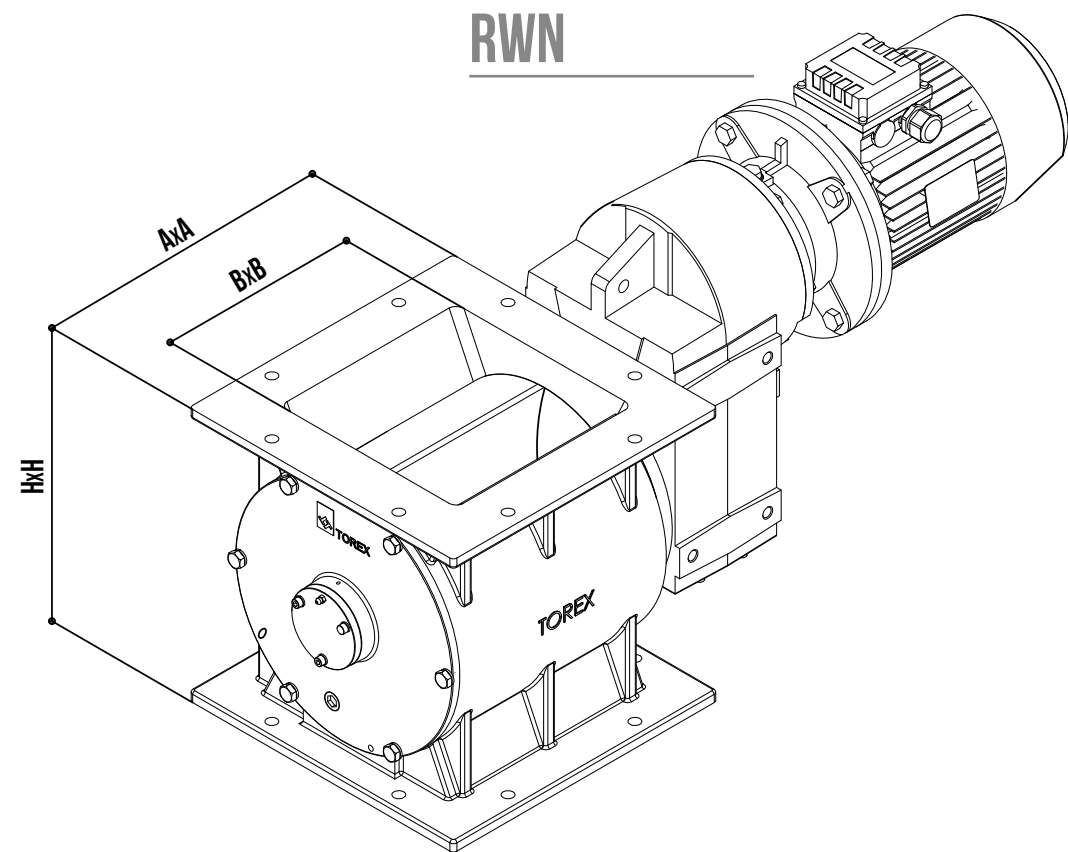

RWN MODEL (dimensions in mm)

Type	A	B	H
RWN 02	265	150	220
RWN 05	320	200	280
RWN 10	375	250	360
RWN 20	440	300	445

TECHNICAL DATA

- Cast iron body;
- Hardox400 rotor;
- Capacity: 2-5-10-20 litres/rev;
- Speed: 20 or 30 rpm;
- Working temperatures: from -20°C to +150°C;
- Tested as a safety device according to dIn En 303-5:2012-10.

RWN...X

Atex rotary valves

ATEX 20/22 certified

EU certificate, type TÜV IT 20 ATEX 011 X



Ex h IIIC T135°C Da/Dc

ATEX rotary valves are designed and tested for use in potentially explosive areas classified as ZONA 22 and with a process atmosphere (inside the valve) classified as ZONA 20 in accordance with Directives 2014/34/EU and 1999/92/EC.

RWN ROTARY VALVE:

The rotary valves are tested for the supply of automatic combustion systems according to the standard En 303-5 : 2012

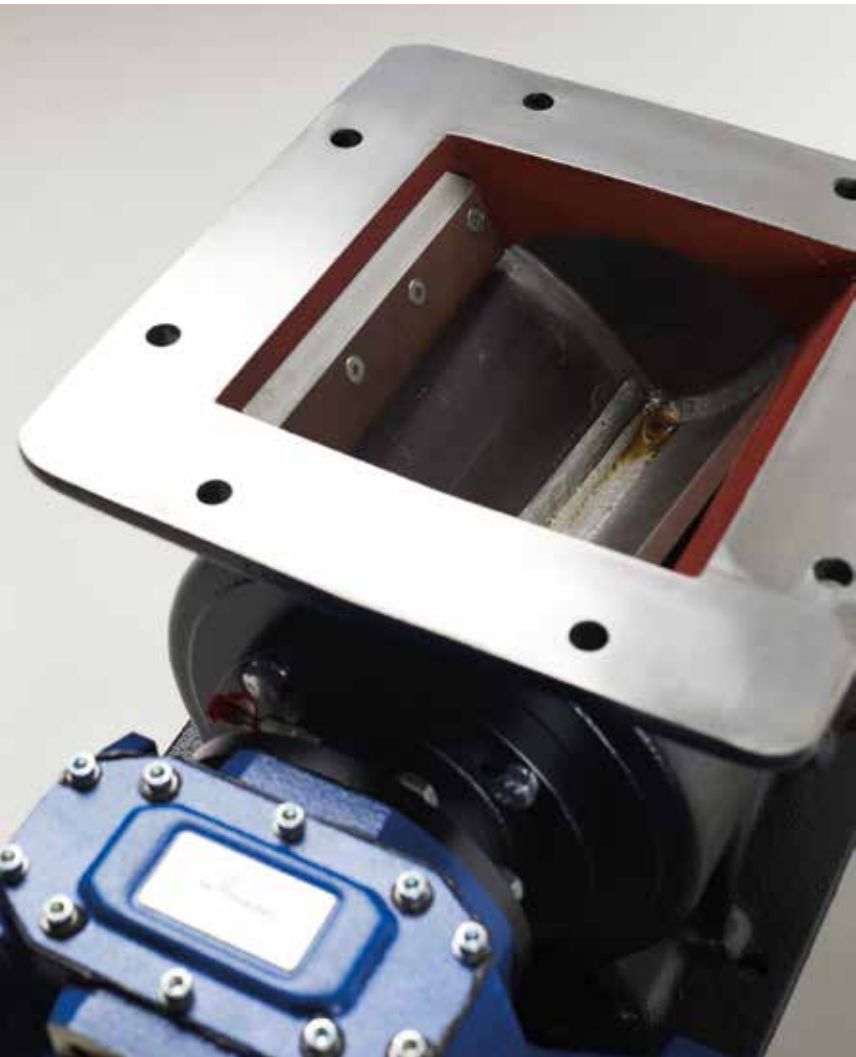



RWN ROTARY VALVES

CONFIGURATION

RWN	10	20	1	0	0	0	0	S	0
	CAPACITY	MOTORISATION	BODY MATERIAL (a)	SILLS	SEALS AND BEARINGS	BODY TREATMENT	ROTOR TREAT. AND MAT.	VALVE VERSION	ROTATION IND. KIT
									<ul style="list-style-type: none"> 0 Without rotation indicator 1 With rotation indicator 2 Rotation ind. without sensor
								<ul style="list-style-type: none"> S Standard X Atex 	
									<ul style="list-style-type: none"> 0 Standard - No treatment
									<ul style="list-style-type: none"> 0 Standard - No treatment
									<ul style="list-style-type: none"> A Seals A.T-Bearings A.T 0 Standard seals and bearings
									<ul style="list-style-type: none"> 0 Without sills
									<ul style="list-style-type: none"> 1 Cast iron
									<ul style="list-style-type: none"> 20 Revolutions per minute (6-pole motor) 30 Revolutions per minute (4-pole motor)
									<ul style="list-style-type: none"> 02 Capacity 2 litres per revolution 05 Capacity 5 litres per revolution 10 Capacity 10 litres per revolution 20 Capacity 20 litres per revolution
									<ul style="list-style-type: none"> RWN Rotary valve for wood type RWN (Square flanges)

ROTARY VALVES



Available from:
FILQUIP PTY LIMITED
 24 Smallwood Street
 Underwood, Qld 4119, Australia
 Ph: +61 7 3208 3499 sales@filquip.com.au
 www.filquip.com.au